

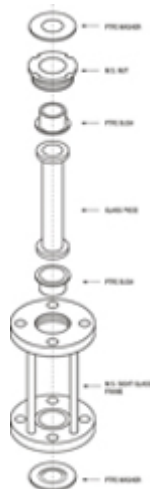

SIGHT FLOW INDICATOR (SIGHT GLASS)



Sight Flow Indicator is used for viewing the fluid in pipelines. The sight flow indicator consists of a straight heavy wall glass tube. It offers virtually no flow restrictions, complete visibility & negligible pressure drop. Available with flange connection, in sizes 25 DN to 150 DN.

A sight flow indicator basically consists of a small housing equipped with a glass window, which is inserted in a run of pipe to observe the flow of the fluid in the pipe.

Sight Flow Indicators are available with special materials to meet various applications. Optional materials are available for the housings or flanges.

Salient Features :



- All contact parts are made of Borosilicate Glass & PTFE.
- Standard Flange Drilling as per ANS116.5, ASA 150#. Other drilling Standard as per BS 10 Table D, E, and F is also available upon request.
- Standard length of glass is 152 mm. Other length is available on request. Face to Face length of Sight Glass is 192mm.
- Standard Material of construction of Housing Frame, Flanges & Studs is M.S Zinc plated. S.S 316, S.S.304 & P.P. can be supplied on request.
- Suitable up to 200°C Temperature.

MS FRAME SIGHT GLASS

DN	L	L1	CAT. REF. TABLE E	CAT. REF. TABLE F	CAT. REF. TABLE ASA
25	192	150	DKS 1/E	DKS 1/F	DKS 1/A
40	192	150	DKS 1.5/E	DKS 1.5/F	DKS 1.5/A
50	192	150	DKS 2/E	DKS 2/F	DKS 2/A
80	192	150	DKS 3/E	DKS 3/F	DKS 3/A
100	192	150	DKS 4/E	DKS 4/F	DKS 4/A
					DKS 6/A
150	192	150	DKS 6/E	DKS 6/F	

SS304 FRAME SIGHT GLASS

DN	L	L1	CAT. REF. TABLE E	CAT. REF. TABLE F	CAT. REF. TABLE ASA
25	192	150	DKS 1/E/304	DKS 1/F/304	DKS1/A/304
40	192	150	DKS1.5/E/304	DKS1.5/F/304	DKS1.5/A/304
50	192	150	DKS2/E/304	DKS2/F/304	DKS2/A/304
80	192	150	DKS3/E/304	DKS3/F/304	DKS3/A/304
100	192	150	DKS4/E/304	DKS4/F/304	DKS4/A/304
150	192	150	DKS6/E/304	DKS6/F/304	DKS6/A/304

SS304 FRAME SIGHT GLASS

DN	L	L1	CAT. REF. TABLE E	CAT. REF. TABLE F	CAT. REF. TABLE ASA
25	192	150	DKS 1/E/316	DKS 1/F/316	DKS1/A/316
40	192	150	DKS1.5/E/316	DKS1.5/F/316	DKS1.5/A/316
50	192	150	DKS2/E/316	DKS2/F/316	DKS2/A/316
80	192	150	DKS3/E/316	DKS3/F/316	DKS3/A/316
100	192	150	DKS4/E/316	DKS4/F/316	DKS4/A/316
150	192	150	DKS6/E/316	DKS6/F/316	DKS6/A/316